



DM5201 Dual-Channel Speed and Phase Reference Monitor

Condition Monitoring

- ✓ Measuring rotation machine speed.
- ✓ Output standard TTL speed and phase reference.
- ✓ System can be used in hazardous area.

Machine Type

- ✓ All kinds of rotation machines.

Feature

- ✓ 4-20mA source.
- ✓ LED indication of system OK, Alert and Danger.
- ✓ 3 1/2 LCD display channel overall.
- ✓ Relay output of Alert and Danger (SPDT).
- ✓ Local and remote RESET/BYPASS.
- ✓ Buffered Output
- ✓ AC power input.

Specifications

Electrical

Power Supply:

- B02: 90~250VAC, 50mA.
- B00: 220VAC+/-20% 50mA
- B01: 110VAC+/-20% 50mA

Speed Response:

0 ~ 50,000 pulse per minute.

Sensor Interface:

- Sensitivity:
8.0mV/um(200mV/mil).

Connectors:

POW/A: Power, -24VDC.

SIG/B: Signal.

COM: Ground and shield.

Buffered Output:

Speed or phase, TTL.

Nominal 0 ~ 5VDC.

Impedance: 100 Ω .

Maximum cable distance: 300m (1000ft).

Overall Speed:

4-20mA, source.

Driving load resistance up to 750 Ω .

Alarm Setup:

0 ~ 100% FS.

Linearity: < 0.1%.

Relays:

Seal: Epoxy.

Capacity: 2A/220VAC or 2A/24VDC, resistive load.

Relay type: SPTD.

Isolation: 1000VDC.

Factory Default:

Relay normally latched and de-energized.

Timed alarm defect is approx. 3 seconds.

Power-up inhibit is set to 10 seconds nominal.

LED Machine Condition Indicator:

Green: Self-test passed, System works OK.

Yellow: Speed over Alert level.

Red: speed over Danger level.

RESET/BYPASS:



Local reset is on monitor front panel.

Remote RESET/BYPASS: Short the connector pin RESET and COM will engage system reset and bypass.

Physical

Weight: 1.0kg (2.0 lb).

Environmental

Temperature:

Operation: 0°C ~ +60°C.

Storage: -40°C ~ +100°C.

Humidity:

90% non-condensing.

Ordering Information

Standard configuration:



DM5201-A01-F00

F02: Customer specify, number of

8mm probe:

TM0180-A07-B00-C05-D10

Extension cable:

TM0181-A40-B00

Driver:

TM0182-A50-B00-C00

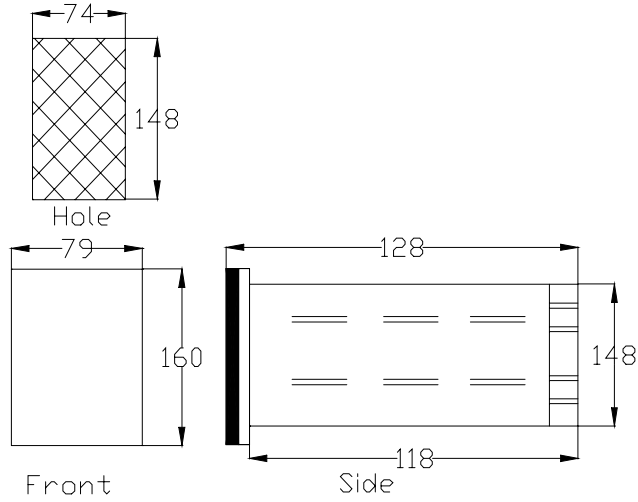

DM5201-AXX-BXX-FXX

AXX: Full Scale

- A00: 0 ~ 1,000 rpm
- A01*: 0 ~ 3,600 rpm
- A02: 0 ~ 6,000 rpm
- A03: 0 ~ 10,000 rpm
- A04: 0 ~ 30,000 rpm
- A05: 0 ~ 50,000 rpm

teeth =XX

* Denote factory default.

TM0180: 8mm probe.

TM0105: 5mm probe.

TM0181: Extension cable.

TM0182: Driver.

BXX: Power Supply

- B00: 220VAC
- B01: 110VAC

DM5201 Accessories

FXX: Teeth per Revolution.

F00*: 1

DM5201 must works with proximity probe transducer.

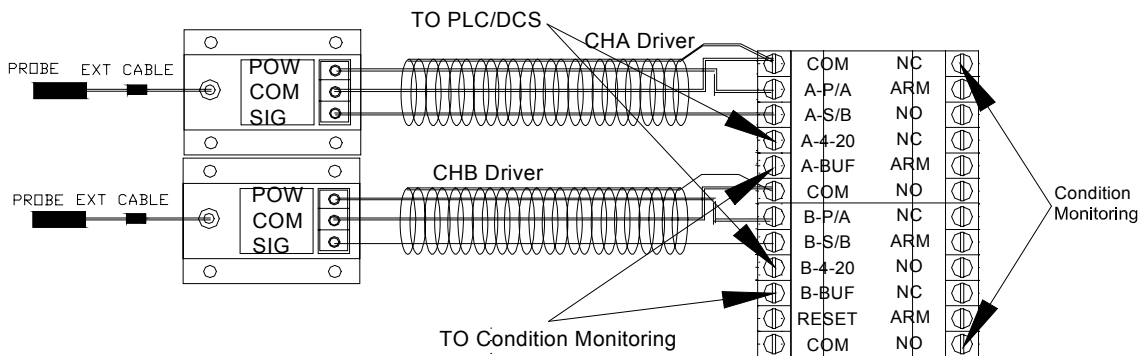

DM5201 Field-wiring Diagram