



DM2202 Dual-Channel Thrust Position/Differential Expansion Monitor

Condition Monitoring

- ✓ Measuring rotation machinery thrust position.
- ✓ Measuring rotor differential expansion due to thermo-expansion.
- ✓ System can be used in hazardous area.

Machine Type

- ✓ All kinds of rotation machines with sleeve bearing. Such as blower, compressor, pump, gearbox, and power generators etc.

Feature

- ✓ 4-20mA source.
- ✓ LED indication of system OK, Alert and Danger.
- ✓ 3 1/2 LCD display channel overall.
- ✓ Relay output of Alert and Danger (SPDT).
- ✓ Local and remote RESET/BYPASS.
- ✓ Buffered Output
- ✓ AC power input.

Specifications

Electrical

Power Supply:

- B02: 90~250VAC, 50mA.
- B00: 220VAC+/-20% 50mA
- B01: 110VAC+/-20% 50mA

Sensor Interface:

- Sensitivity: 8.0 mV/um (200mV/mil).
- Connectors:
 - POW/A: Power, -24VDC.
 - SIG/B: Signal.
 - COM: Ground and shield.

Buffered Output:

Original vibration, un-filtered.

Nominal 2-18VDC.

Impedance: 100 Ω .

Maximum cable distance: 300m (1000ft).

Sensitivity: 8.0 mV/um (200mV/mil) nominal.

Overall Displacement:

4-20mA, source.

Driving load resistance up

to 750 Ω .

Alarm Setup:

0 ~ 100% FS.

Accuracy: ±0.1%.

Relays:

Seal: Epoxy.

Capacity: 2A/220VAC or 2A/24VDC, resistive load.

Relay type: SPDT.

Isolation: 1000VDC.

Factory Default:

Relay normally latched and de-energized.

Timed alarm defect is approx. 3 seconds.

Power-up inhibit is set to 10 seconds nominal.

LED Machine Condition Indicator:

Green: Self-test passed, System works OK.

Yellow: Vibration over Alert level.

Red: Vibration over Danger level.

RESET/BYPASS:

Local reset is on monitor front panel.

Remote RESET/BYPASS: Short the connector pin RESET and

COM will engage system reset and bypass.

Physical

Weight: 1.0kg (2.0 lb).



Environmental

Temperature:

Operation: 0°C ~ +60°C.

Storage: -40°C ~ +100°C.

Humidity:

90% non-condensing.

Ordering Information

Standard configuration:

DM2202-A00

8mm probe:

TM0180-A07-B00-C05-D10

Extension cable:

TM0181-A40-B00

Driver:

TM0182-A50-B00-C00

DM2202-AXX-BXX

AXX: Full Scale

A00*: 1.0 ~ 0 ~ 1.0mm

(require TM0180 or other 8mm proximity probe transducer;

TM0105 or other 5mm proximity probe transducer)



- A01: 2.0 ~ 0 ~ 2.0mm
(require TM0110 or other 11mm proximity probe transducer)
- A02: 6.0 ~ 0 ~ 6.0mm
(require TM0120 or other 25mm, 35mm proximity probe transducer)
- A03: 12.0 ~ 0 ~ 12.0mm
(require TM0150 or other 50mm proximity probe transducer)
- A04: 40 ~ 0 ~ 40mil
(require TM0180 or other 8mm proximity probe transducer; TM0105 or other 5mm proximity probe transducer)
- A05: 80 ~ 0 ~ 80mil
(require TM0110 or other 11mm proximity probe transducer)
- A06: 0.25 ~ 0 ~ 0.25inch
(require TM0120 or other 25mm, 35mm proximity probe transducer)
- A07: 0.5 ~ 0 ~ 0.5inch
(require TM0150 or other 50mm proximity probe transducer)

BXX: Power Supply

B00: 220VAC

TM0110: 11mm probe.

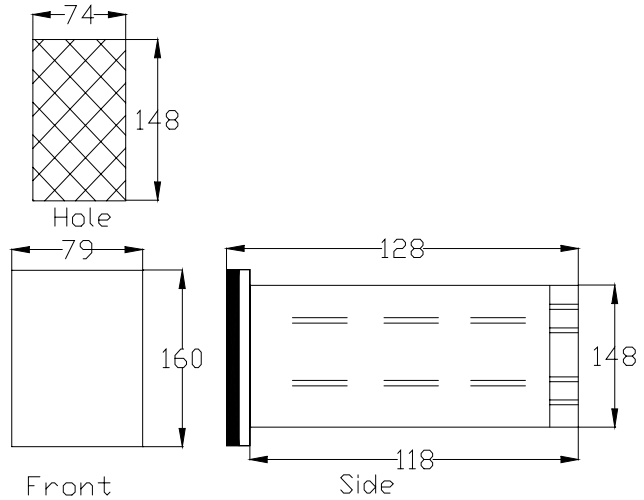

B01: 110VAC

* Denote factory default.

TM0120: 25mm probe.

TM0181: Extension cable.

TM0182: 8mm, and 5mm driver.

TM0112: 11mm driver.

TM0122: 25mm driver.

DM2202 Accessories

DM2202 must work with proximity probe transducer.

TM0180: 8mm probe.

TM0105: 5mm probe.

DM2202 Field-wiring Diagram

