



## DM2201 Dual-Channel Shaft Vibration Monitor

### Condition Monitoring

- ✓ Measuring rotation machinery shaft vibration.
- ✓ Monitoring vibration increase due to shaft imbalance, misalignment, looseness etc.
- ✓ System can be used in hazardous area.

### Machine Type

- ✓ All kinds of rotation machines with sleeve bearing. Such as blower, compressor, pump, gearbox, and power generators etc.

### Feature

- ✓ 4-20mA source.
- ✓ LED indication of system OK, Alert and Danger.
- ✓ 3 1/2 LCD display channel overall.
- ✓ Relay output of Alert and Danger (SPDT).
- ✓ Local and remote RESET/BYPASS.
- ✓ Buffered Output
- ✓ AC power input.

### Specifications

#### Electrical

Power Supply:

- B02: 90~250VAC, 50mA.
- B00: 220VAC+/-20% 50mA
- B01: 110VAC+/-20% 50mA

Frequency Response ( $\pm 3$ dB):

- 2.0 ~ 5.0KHz.
- Low frequency options: 0.5 ~ 100Hz.

Sensor Interface:

Sensitivity:

8.0 mV/um (200mV/mil).

Connectors:

- POW/A: Power, -24VDC.
- SIG/B: Signal.
- COM: Ground and shield.

Buffered Output:

- Original vibration, un-filtered.
- Nominal 2-18VDC.
- Impedance: 100  $\Omega$ .
- Maximum cable distance: 300m (1000ft).
- Sensitivity: 8.0mV/um (200mV/mil) nominal.

Overall Vibration:

- 4-20mA, source.
- Driving load resistance up to 750  $\Omega$ .

Alarm Setup:

- 0 ~ 100% FS.
- Accuracy:  $\pm 0.1\%$ .

Relays:

- Seal: Epoxy.
- Capacity: 2A/220VAC or 2A/24VDC, resistive load.
- Relay type: SPTD.
- Isolation: 1000VDC.

Factory Default:

- Relay normally latched and de-energized.
- Timed alarm defect is approx. 3 seconds.
- Power-up inhibit is set to 10 seconds nominal.

LED Machine Condition Indicator:

- Green: Self-test passed, System works OK.
- Yellow: Vibration over Alert level.
- Red: Vibration over Danger level.

RESET/BYPASS:



Local reset is on monitor front panel.  
Remote RESET/BYPASS: Short the connector pin RESET and COM will engage system reset and bypass.

### Physical

Weight: 1.0kg (2.0 lb).

### Environmental

Temperature:

- Operation: 0°C ~ +60°C.
- Storage: -40°C ~ +100°C.

Humidity:

- 90% non-condensing.

### Ordering Information

Standard configuration:

**DM2201-A00**

8mm probe:

**TM0180-A07-B00-C05-D10**

Extension cable:

**TM0181-A40-B00**

Driver:



TM0182-A50-B00-C00

**DM2201-AXX-BXX**

**AXX: Full Scale**

- A00\*: 0 ~ 200um pk-pk
- A01: 0 ~ 1000um pk-pk
- A02: 0 ~ 100um pk-pk
- A03: 0 ~ 10mil pk-pk
- A04: 0 ~ 50mil pk-pk
- A05: 0 ~ 5.0mil pk-pk
- A06: 0 ~ 200um pk-pk (0.5 ~ 100Hz)
- A07: 0 ~ 1000um pk-pk (0.5 ~ 100Hz)
- A08: 0 ~ 100um pk-pk (0.5 ~ 100Hz)

**BXX: Power Supply**

- B00: 220VAC
- B01: 110VAC

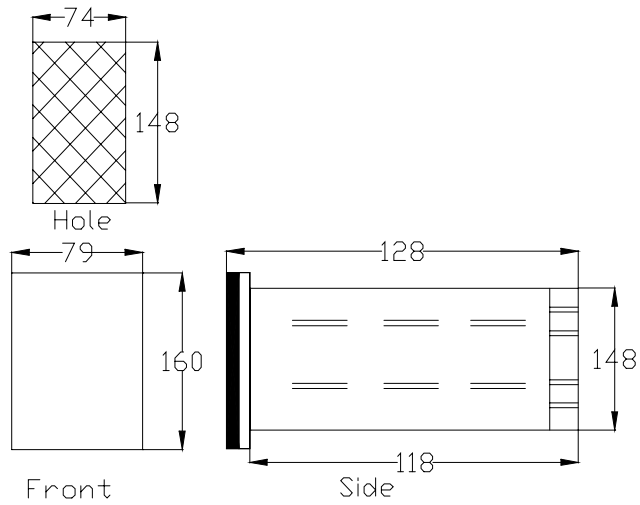

\* Denote factory default.

**TM0180:** 8mm probe.

**TM0105:** 5mm probe.

**TM0181:** Extension cable.

**TM0182:** Driver.

**DM2201 Accessories**

DM2201 must work with proximity probe transducer.

**DM2201 Field-wiring Diagram**

